

TAKSTAR® 得胜

CS-200 全向会议麦克风音箱 Speakerphone



使用手册 User Manual

CS-200 全向会议麦克风音箱

■ 前言

尊敬的用户：

感谢您选购得胜CS-200全向会议麦克风音箱，为了您能够更好地了解使用本产品，建议您在使用前仔细阅读本说明书。

若存在有疑问或者您有宝贵的建议，可通过拨打得胜官方服务热线400 6828 333或微信扫描二维码关注得胜官方公众号与我们联系。



■ 产品特性

- 专为视频会议、远程教学、远程培训等场合而设计的视频会议全向麦克风
- 集麦克风与扬声器于一体，全双工模式，收音、放音同时满足
- 4个麦克风阵列，5米半径收音范围，360度无死角拾音
- 自动人声定位技术，能自动侦测发言者方向并将拾音聚焦发言者
- 搭配智能算法，自动消除回音，有效屏蔽环境噪声
- 支持无线和USB连接，适用多种音视频通讯软件，实现多方通话
- 触摸式操作面板，操作灵敏便捷，避免传统开关带来的机械噪声
- 小巧便携，免驱动，即连即用，随时随地满足远程办公需要
- 内置可充电锂电池，强劲续航，使用约10小时

CS-200 全向会议麦克风音箱

■ 包装清单

| | |
|--------------|----|
| 全向麦克风音箱..... | 1只 |
| 收纳盒..... | 1个 |
| 数据线..... | 1条 |
| 说明书..... | 1份 |

■ 适用范围

适用于视频会议、远程教学、远程培训等场合

■ 技术参数

- 扬声器输出功率：3W
- 扬声器频率响应：20Hz-20KHz
- 麦克风数量：4个麦克风阵列
- 麦克风指向性：全指向（360拾音范围）
- 麦克风频率响应：50Hz-16kHz
- 麦克风灵敏度：-26dB
- 麦克风失真度：≤1% at 1KHz
- 连接方式：USB2.0/无线
- 采样率：96kHz
- 比特率：26bit
- 无线距离：10米
- 双工音频：支持
- 回声消除：支持
- 麦克风阵列降噪：支持
- 人声定位：支持
- 供电模式：3.7V/2600mAh
锂电池
- 充电规格：5V \equiv 1A
- 充电时间：约3小时
- 使用时间：约10小时

注：以上数据由得胜实验室测试得到，并拥有最终解释权！

CS-200 全向会议麦克风音箱

■ 功能示意：

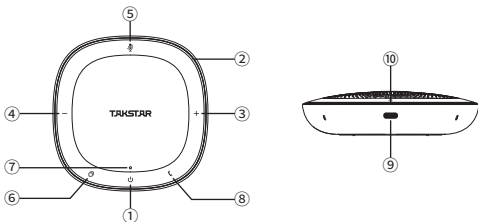

- ① 电源开关：长按电源开关1秒开机或关机；开机状态下短按电源开关显示当前电量；
- ② 指示灯环：根据工作状态显示音量、电量、静音状态、拾音方向指示等；
- ③ 音量“+”键：短按增大音量，长按快速增大音量；
- ④ 音量“-”键：短按减小音量，长按快速减小音量；
- ⑤ 静音按键：短按开启或关闭麦克风；
- ⑥ 模式按键：模式切换，短按切换无线连接和USB连接模式；无线模式下，长按2秒进入设备配对模式；长按5秒，复位无线连接功能，清除所有配对信息；
- ⑦ 状态指示灯：蓝色为无线连接模式，白色为USB连接模式；
- ⑧ 接听按键：短按接听、挂断电话；长按拒接来电；
- ⑨ 数据接口：连接电脑数据传输及供电；或连接输出为DC 5V \equiv 1A以上的充电器进行充电（充电器必须兼容5V输出才能适配）；
- ⑩ 充电指示灯：充电显示红色，充满显示绿色；

CS-200 全向会议麦克风音箱

■ 使用说明：

PC/MAC

1. 通过USB连接线将音箱与电脑USB插口连接（音箱将自动充电），电脑将自动识别并完成驱动安装，即可进行USB传输数据，且状态指示灯长亮白色；

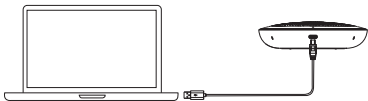

电脑连接线

2. 驱动设置

- PC：将系统喇叭的“播放”“录制”设备“TAKSTAR CS-200”设置为默认设备；



CS-200 全向会议麦克风音箱

macOS: “系统偏好设置” / “声音”，将“输入”和“输出”选项卡选择“TAKSTAR CS-200”；



3. 开启视频会议软件、即时通讯软件等，即可进行网络会议、视频通话等。

手机/Pad

1. 首次使用无线模式时，状态指示灯蓝色闪烁，表示设备进入搜索配对状态；
2. 进入手机/Pad的“设置”菜单，搜索配对设备，待搜索到“TAKSTAR CS-200”，点击进行连接，连接成功后，蓝色长亮；
3. 开启视频会议软件、即时通讯软件等，即可进行网络会议、视频通话等。

注：设备已与音箱配对的情况下，开机自动回连；长按2秒模式按键，进入配对模式。

CS-200 全向会议麦克风音箱

■ 安全警示

为避免电击、高温、着火、辐射、爆炸、机械危险以及使用不当等可能造成的人身伤害或财产损失，使用本产品前，请仔细阅读并遵守以下事项：

1. 使用产品时请确认所连设备与本产品功率是否匹配以及合理调整音量大小，不要在超过产品功率及大音量下长时间使用，以免造成产品损伤和听力异常；
2. 使用中若发现有异常（如冒烟、异味等），请立即关闭电源开关并拔掉电源插头，然后将产品送经销商检修；
3. 本产品及配件都应放置在室内干燥通风处，请勿长期存放在潮湿、灰尘多的环境，使用中避免靠近火源、雨淋、进水、过度碰撞、抛掷、振动本机及覆盖通风孔，以免损坏其功能；
4. 若产品需要固定于墙壁或天花板时，请确保固定到位，防止因固定强度不足导致产品发生跌落危险；
5. 使用该产品时需遵守相关安全规定，法律法规明确禁止使用场合请勿使用本机，以免导致意外事故；
6. 请不要自行拆机改装或维修，以防止出现人身伤害，如有问题或服务请联系当地经销商跟进处理。

CS-200 全向会议麦克风音箱

■ 关于图标含义解释



该图标表示产品符合“中国强制性产品认证”3C认证要求。



根据RL2004/108/EG和European Low Voltage Directive (欧洲低电压指令) RL2006/95/EG的测试结果表明,本产品符合欧共体关于电磁兼容性的成员国法律整合的指令中所规定的限值。



未经合规方明确批准的变更或修改可能会使用户失去操作设备的权限。

此设备符合FCC规则第15部分中的规范。操作设备须符合以下两个条件:

- (1) 此设备不会导致有害干扰;
- (2) 此设备可承受任何外来干扰,包括可能导致非预期操作的干扰。



此符号表示,根据WEEE指令(2012/19/EU)和国家法律,由于这种类型的废弃物会有潜在的有害物质,可能对环境 and 人类健康产生负面影响,所以本产品不应与您的家庭垃圾一起处置,应将本产品交由授权的电气和电子设备(WEEE)回收站回收。同时,您在正确处理本产品的同时将有助于自然资源的有效利用。如需了解更多有关您可以在何处放置废物回收设备的信息,请联系您当地的城市办事处、废物管理局或家庭废物处理服务部门。

CS-200 全向会议麦克风音箱

■ 关于本说明书

本说明书中内容符合截止印刷之日的技术规格。由于得胜公司会不断改进产品，本说明书可能不符合您的特定产品的技术规格。要获取最新版说明书，请访问得胜官网，然后下载说明书文件。技术规格、设备或另售的附件在各个地区可能有所不同，如有问题请与当地得胜经销商确认。如需更多支持和深层产品信息，请浏览得胜官方网站：<https://www.takstar.com/>

■ 环保说明

产品中有毒有害物质或元素的名称及含量标识表

| 部件名称 | 有毒有害物质或元素 | | | | | |
|-------|-----------|-----------|-----------|-----------------|---------------|-----------------|
| | 铅 (Pb) | 汞 (Hg) | 镉 (Cd) | 六价铬 (Cr(VI)) | 多溴联苯 (PBB) | 多溴二苯醚 (PBDE) |
| 塑料部件 | ○ | ○ | ○ | ○ | ○ | ○ |
| 金属部件 | × | ○ | ○ | ○ | ○ | ○ |
| 电路板组件 | × | ○ | ○ | ○ | ○ | ○ |
| 线缆 | × | ○ | ○ | ○ | ○ | ○ |

本表格依据SJ/T 11364的规定编制。

○: 表示该有害物质在该部件所有均质材料中的含量均在 GB/T 26572 规定的限量要求以下。

×: 表示该有害物质至少在该部件的某一均质材料中的含量超出 GB/T 26572 规定的限量要求。

此标志为产品的环保使用期限标志，
且此环保使用期限只适用于产品正常工作的温度和湿度等条件。





扫一扫，了解更多产品
Scan for more
product information

广东省电声工程技术研究开发中心 广东得胜电子有限公司制造

地址：广东省惠州市博罗县龙溪街道富康一路2号
服务热线：400 6828 333 传真：0752 6383950
邮箱：xs@takstar.com
网址：www.takstar.com

Guangdong Takstar Electronic Co., Ltd.
Address: No. 2 Fu Kang Yi Rd., Longxi Boluo
Huizhou, Guangdong 516121 China
Tel: 86 752 6383644 Fax: 86 752 6383952
Email: sales@takstar.com
Website: www.takstar.com

CS-200 Speakerphone

■ Preface

Dear Customer,

Thank you for purchasing Takstar CS-200 Speakerphone. In order to better understand and use the product, please read this manual carefully before use.

If you have any questions or suggestions, please contact our local dealer.

■ Features

- Omni-directional speakerphone designed for remote conference/learning/training.
- Full-duplex microphone & speaker combo, record and playback simultaneously.
- 4 microphone arrays, 360° coverage, up to 5m vocal pickup range.
- Automatic vocal location detects and focuses on the speaker.
- Coupled with intelligent algorithm for automatic echo cancellation for clear sound.
- Compatible with various audio/video communication software, connects via Wireless or USB mode.
- Easy touch control prevents mechanical noise from conventional switch.
- Portable, driverless, plug and play anytime, anywhere for remote office needs.
- Powerful lithium-ion battery inside lasts for around 10hrs of use.

CS-200 Speakerphone

■ Package Contents

| | |
|--------------------|-----|
| Speakerphone..... | 1pc |
| Carrying Case..... | 1pc |
| Data Cable..... | 1pc |
| User Manual..... | 1pc |

■ Applications

Video conference, distance education, remote training.

■ Specifications

- Speaker Output Power: 3W
- Speaker Frequency Response: 20Hz-20KHz
- Number of Mic: 4 microphone arrays
- Mic Polar Pattern: omni-directional (360° pickup)
- Mic Frequency Response: 50Hz-16kHz
- Mic Sensitivity: -26dB
- Mic Distortion: $\leq 1\%$ at 1KHz
- Connection: USB2.0/Wireless
- Sample Rate: 96kHz
- Bit Rate: 26bit
- Wireless Range: 10m
- Duplex Audio: supported
- Echo Cancellation: supported

CS-200 Speakerphone

- Mic Array Noise Cancellation: supported
- Vocal Location: supported
- Power Supply: 3.7V/2600mAh li-ion battery
- Charging Spec: 5V/1A
- Charging Time: approx. 3hrs
- Battery Life: approx. 10hrs

Note: The above data is measured by Takstar laboratory, and Takstar has the final interpretation right!

■ Function Descriptions

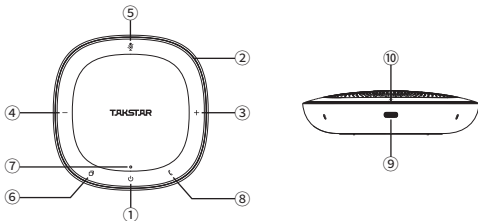

① Power Switch: press and hold for 1s to power on/off; when powered on, tap to display current battery level.

CS-200 Speakerphone

- ② Ring Indicator: displays volume/ battery level/ mute status/ pickup direction, based on device work status.
- ③ Volume Up “+” : tap to increase volume, or press and hold to increase rapidly.
- ④ Volume Down “-” : tap to decrease volume, or press and hold to decrease rapidly.
- ⑤ Mute Button: tap to enable/disable microphone.
- ⑥ Mode Button: tap to switch between Wireless mode or USB mode. Under Wireless mode, press and hold for 2s to enter device pairing mode. Press and hold for 5s to reset Wireless function and clear all pair data.
- ⑦ Status Indicator: blue under Wireless mode, or white under USB mode.
- ⑧ Answer Call Button: tap to answer/end call; press and hold to reject incoming call.
- ⑨ Data Port: connects to a computer for data transfer and power supply; or connects to a charger with output power \geq DC 5V \equiv 1A. (the charger must have compatible 5V output.)
- ⑩ Charging Indicator: red while charging, green when fully charged.

CS-200 Speakerphone

■ Operation Instructions

PC/MAC

1. Connect the speakerphone to computer USB socket using a USB cable, (speakerphone will auto charge), USB data transfer will start once the computer automatically recognizes the device and completes driver installation, in which case the status indicator will light up in solid white.

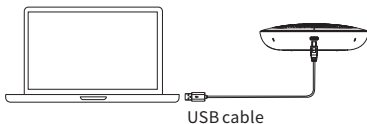

2. PC: set TAKSTAR CS-200 as the default device for both Playback and Recording in your system sound settings.

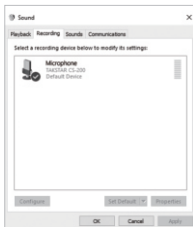
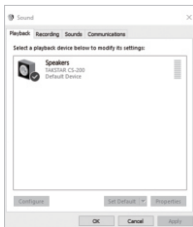

CS-200 Speakerphone

macOS: select TAKSTAR CS-200 in both Input and Output tabs under System Preferences – Sound.



3. Open your videoconference or instant communication software to start network conversations.

Smartphone/Tablet

1. Upon first use of Wireless mode, the status indicator flashes blue while searching device to pair.
2. Search device to pair in your smartphone/tablet Settings, wait until “TAKSTAR CS-200” is discovered, then tap on it to connect. Once connected successfully, the indicator will light up blue.
3. Open your videoconference or instant communication software to start network conversations.

Note: The speakerphone will automatically reconnect to previously paired device.

Press and hold Mode Button for 2s to enter pairing mode.

CS-200 Speakerphone

■ Safety Instructions

To avoid electric shock, overheat, fire, radiation, explosion, mechanical risk and injury or property loss due to improper use, please read and observe the following items before use:

1. Please check if the power of the connected equipment matches with that of this product before operation. Adjust the volume to proper level during operation. Do not operate at over-power or high-volume level for extended time to avoid product malfunction or hearing impairment.
2. If there is any abnormality during use (e.g., smoke, strange odor), please kill the power switch and unplug from power source, then send the product to the local dealer for repair.
3. Keep this product and its accessories in a dry and ventilated area. Do not store in a humid or dusty area for extended time. Keep away from fire, rain, liquid intrusion, bumping, throwing, vibrating, or from blocking any ventilation openings, to prevent malfunction.
4. The product must, when installed on walls or ceilings, be fixed firmly in place at adequate strength to prevent from falling.
5. Please abide by safety rules during operation. Do not use the product in places prohibited by laws or regulations to avoid accident.
6. Do not disassemble or repair the product by yourself to avoid injury. If you have any questions or require any services, please contact our local dealer.

CS-200 Speakerphone

■ Label Meanings



This icon indicates that the product meets the 3C certification requirements of “China Compulsory Product Certification” .



According to the test results obtained based on RL2004 /108/EG (Electromagnetic Compatibility Directive) and RL2006/95/EG (Low Voltage Directive), this product complies with the limits specified in the European Community EMC (Electromagnetic Compatibility) Directive, an integration of relevant laws from its member states.



Changes or modifications not expressly approved by the party responsible for compliance could void the user's authority to operate the equipment.

This device complies with Part 15 of the FCC Rules. Operation is subject to the following two conditions:

- (1) this device may not cause harmful interference, and
- (2) this device must accept any interference received, including interference that may cause undesired operation.

CS-200 Speakerphone



This symbol indicates that, according to WEEE (Waste of Electrical and Electronic Equipment) Directive (2012/19/EU) and national laws, this type of waste should not be discarded along with your household waste, as it contains potentially hazardous substances that may pose a negative impact on the environment and human health. It should be handed over to an authorized WEEE collection facility for recovery and recycle. By doing so, you will be helping effective utilization of natural resources. For more information on disposal of WEEE products, please contact your local municipal office, waste management bureau or household waste disposal service.

■ About This Manual

This manual contains up-to-date technical specifications as of printing. However, this manual may not contain specifications conforming to your particular product since Takstar is constantly improving its products. For the latest version/more information, please visit our website: <https://www.takstar.com/>.

Specifications, devices or accessories available may vary from region to region. If you have any questions, please contact our local dealer.

注意事项:

1. 本单为保修凭证, 请用户妥善保管, 如有遗失, 恕不保修或退换。
2. 保修期限制: 购买之日起十二个月内。
3. 除了不可抗力事件损坏外, 由本公司负责, 免费维修。
4. 如属保管不善或使用不当造成的损坏, 维修点将酌情收费。
5. 擅自拆卸维修者, 不予保修。
6. 以上保修条款仅限于中国市场适用 (不含港澳台地区)。

产品服务保证书

姓名: _____ 电话: _____ 地址: _____
商品: _____ 型号: _____ 购买日期: _____ 年 ____ 月 ____ 日

| 维修记录栏 (由维修员填写) | 维修员签名 | 日期 |
|----------------|-------|----|
| | | |
| | | |
| | | |
| | | |
| | | |
| | | |

◆广东得胜电子有限公司 ◆电话: 400-6828-333 ◆地址: 广东省惠州市博罗县龙溪街道富康一路2号